

ANCHOR AUDIO WIRELESS

CHANNEL SELECTION - BUILT-IN RECEIVER

1. Choose any available wireless channel from 1 thru 16
2. Set the Wireless Channel Selection Knob to the channel you choose in step 1

If you have two wireless receivers repeat above for the second receiver. **Remember**, each receiver/transmitter pair must be set to different channels to avoid interference.

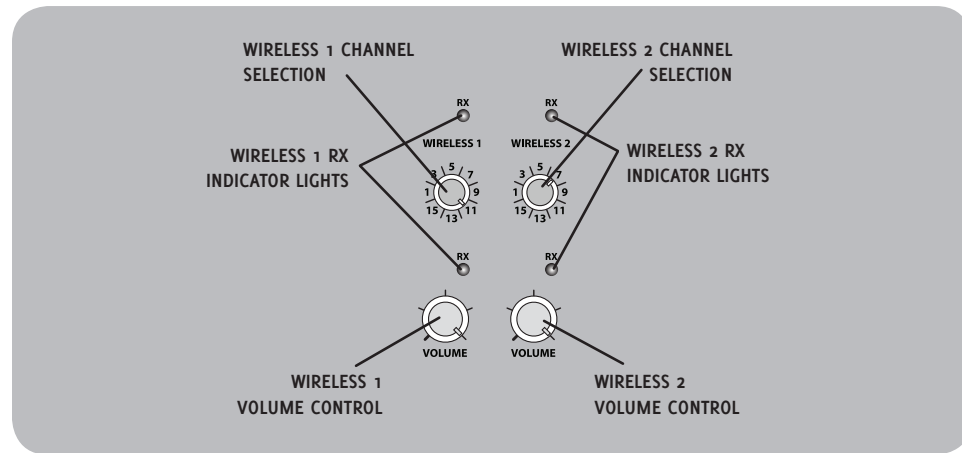

OPERATING THE WIRELESS MICROPHONE/TRANSMITTER

CHANNEL SELECTION - HANDHELD TRANSMITTER

1. Unscrew battery cover on bottom of microphone
2. Set the CHANNEL SELECTOR dial to match the channel setting of your receiver
3. Replace battery cover and tighten firmly

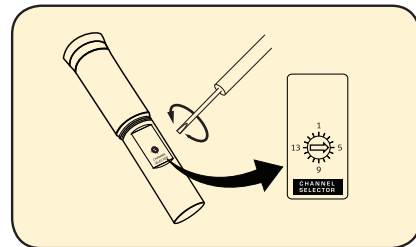

The wireless RX indicators will light (*only one indicator will light at a time*) when the wireless signal is being transmitted and received

CHANNEL SELECTION - BODY-PACK TRANSMITTER

1. The channel selection dial is located on the side of the transmitter
2. Set the CHANNEL selection dial to match the channel setting of the receiver

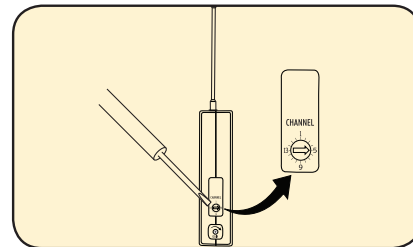

SOUND SYSTEM PLACEMENT

CORRECT SYSTEM PLACEMENT

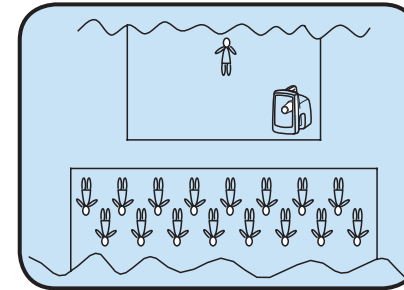

WRONG SYSTEM PLACEMENT

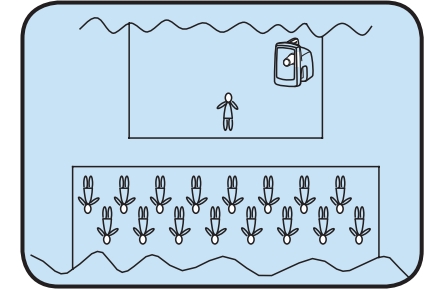

(having the microphone too close to front of unit may cause feedback)

AC OPERATION & BATTERY CHARGING/INDICATORS

MegaVox Sound Systems includes an automatic charging system designed to properly charge and maintain the systems built-in battery. To charge battery plug the power cord into your sound system. Plug the other end of the cord into AC outlet - Charger LED will stay on during charging. Battery fully charged in approximately 15 - 20 hrs - Charger LED will flash. When in AC mode the system automatically transfers power from the battery charger to the power amplifier at high volume output, causing the Charger LED to flicker.

SYSTEM STORAGE & BATTERY

Fully charge batteries before first use and storage. For extended periods of storage either leave system plugged into an AC outlet or charge the system at least once each month for a minimum of 24 hours.

BUILT-IN BATTERY MAINTENANCE

To preserve battery life the built-in battery **MUST** be FULLY charged before the first use. Regardless of length of operation, it is recommended that the battery be fully charged as soon as possible after each use.

HAVING TROUBLE WITH YOUR SOUND SYSTEM?

CONDITION	POSSIBLE SOLUTION
No Sound (<i>power LED off</i>)	<ul style="list-style-type: none"> • turn POWER switch ON • charge battery or plug in AC cord • safely shut down if unit overheats, turn volume lower & turn speaker ON

No Sound (<i>power LED on</i>)	<ul style="list-style-type: none"> • check for output from source • make sure all cables are completely plugged in • turn up volume control of input used • remove plug from speaker output if not using external speaker output
----------------------------------	--

Shortened Battery Life	<ul style="list-style-type: none"> • charge battery fully; if battery life continues to deteriorate, contact Anchor Audio customer service: 800.262.4671
------------------------	---

Distorted Sound	<ul style="list-style-type: none"> • lower system volume control • lower input volume control
-----------------	---

Excessive Hum or Noise	<ul style="list-style-type: none"> • use shielded cables • use balanced microphone
------------------------	--

HAVING TROUBLE WITH YOUR WIRELESS SYSTEM? (Wireless Models Only)

CONDITION	POSSIBLE SOLUTION
No Sound (<i>RX Indicator: ON</i>)	<ul style="list-style-type: none"> • turn up WIRELESS volume control • make sure mic is plugged into body pack transmitter

No Sound (<i>RX Indicator: OFF</i>)	<ul style="list-style-type: none"> • push mic power button • turn MegaVox POWER switch on • make sure transmitter power switch is on • set receiver and transmitter to same channel • replace battery in transmitter
---------------------------------------	---

The MegaVox public address system comes with a six year warranty, and all Anchor Audio batteries and wireless come with a two year warranty.

NEED MORE HELP? MegaVox Sound System Setup & Operation Videos!
Visit Our Website: www.anchoraudio.com



100-0229-000

MEGAVOX PUBLIC ADDRESS SYSTEM

You can view a demonstration video complete with a trouble shooting section at www.anchoraudio.com.

Please check your new unit carefully for any damage which may have occurred during shipment.

CONNECTING MULTIPLE SOUND SYSTEMS

UNPOWERED COMPANION SPEAKER

Connect one end of a speaker cable (SC-50) to the SPKR OUT jack on the back of a powered MegaVox PRO PA system. The other end connects to the jack labeled IN on the back of a MegaVox PRO unpowered companion speaker.

NOTE: AC power is not required for an unpowered companion speaker.

POWERED SOUND SYSTEMS

Connect speaker cable (SC-50) from LINE OUT on first powered MegaVox PRO to LINE IN on second powered MegaVox PRO. Set volume level of the second system to maximum, this gives full volume control to the first or primary PA system.

DAISY-CHAINING

Use the Line Out method above to connect up to six powered MegaVox PRO PA Systems. Make all connections with power off. Set volume level to maximum on all secondary systems so the primary unit Level Control sets the volume for the entire chain. To avoid speaker popping, which can cause damage, power speakers on in order, primary unit first, and power speakers off in reverse order, primary unit last.

Anchor Audio, Inc. • (800) 262-4671 • www.anchoraudio.com